

The Marri

New home design.

No more to pay. Just move in.



No Stamp Duty • No Water or Land Rates • No Sales Commission When You Sell • You Own Your Own Home • Pensioner Rebates Available

Helena
Valley
Lifestyle
Village



The Marri

**BELONG TO A VIBRANT,
EXCLUSIVE COMMUNITY**

The Marri design is a one bedroom home with a fully equipped kitchen and dining area, with open plan living leading out to a covered outdoor entertaining area and beautifully landscaped native gardens.

It comes with a brick paved carport, window treatments, and external storage room.



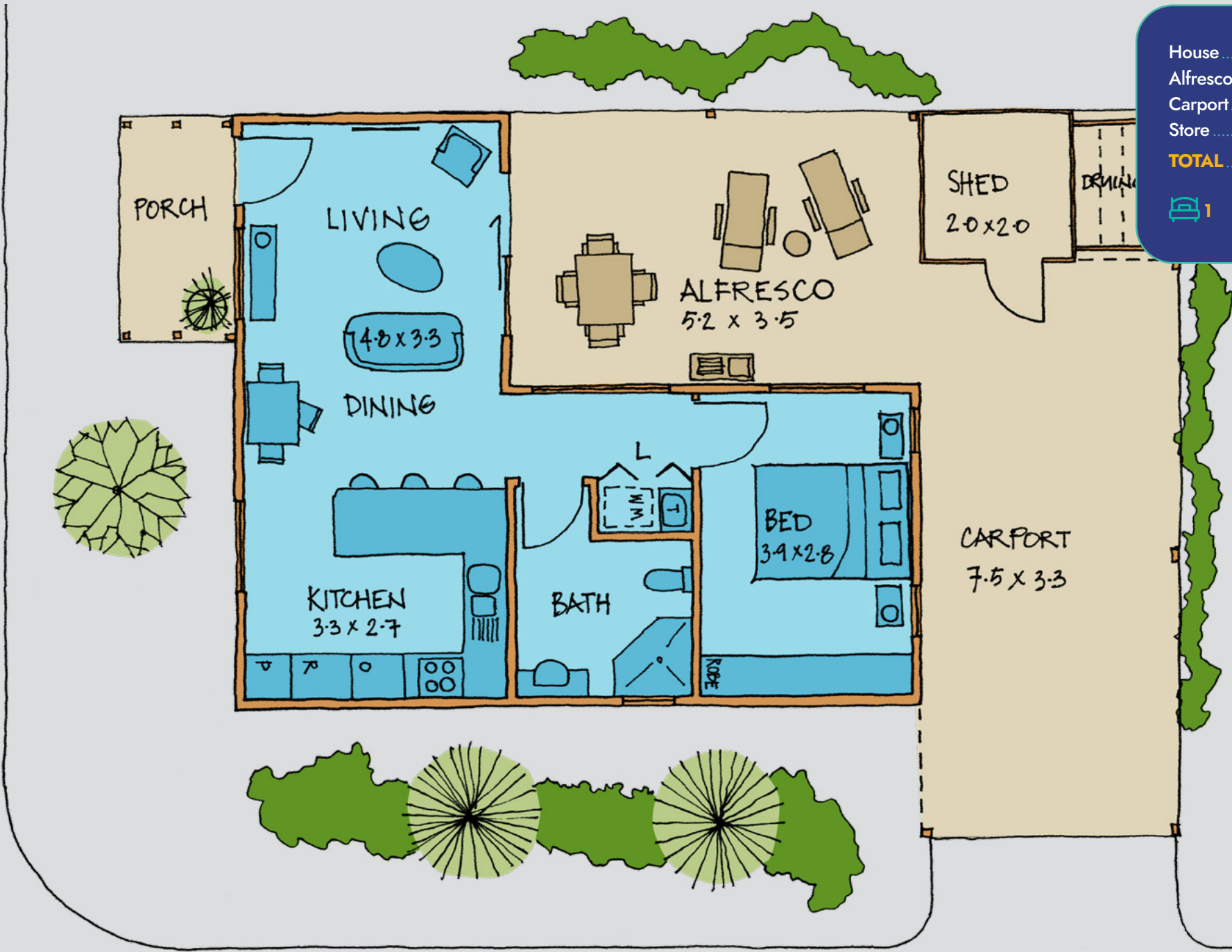

House	42.7m ²
Alfresco & Porch	23.7m ²
Carport	19m ²
Store	4m ²
TOTAL	89.4m²

1
 1
 1
 1

All images and floor plans for illustration purposes only.
 Information correct as of May 2024 and subject to change without notice. Terms and conditions apply.

INCLUSIONS

- One bedroom
- One bathroom
- 1 WC
- Alfresco area off living/dining
- Open-plan kitchen, dining and living area
- Built-in robes in bedroom
- All fixtures and fittings included
- Undercover carport
- Drying court
- Store room
- Fully landscaped gardens
- Paved driveway, carport and outdoor alfresco area
- Roof and external wall insulation
- Laundry in a separate alcove with doors



2340 Helena Valley Rd, Helena Valley

p 08 6298 0888

e helenavalley@nlv.com.au

w helenavalleylifestyle.com.au

f facebook.com/helenavalleylifestyle

Helena Valley
Lifestyle Village



Call
Richard Nowland
0400 219 691



Call
Mark Emberson
0404 852 272

helenavalleylifestyle.com.au